

TYPICAL ( 1ST, ND, 3RD, 4TH, & 5TH ) FLOOR PLAN

6TH. FL. PLAN

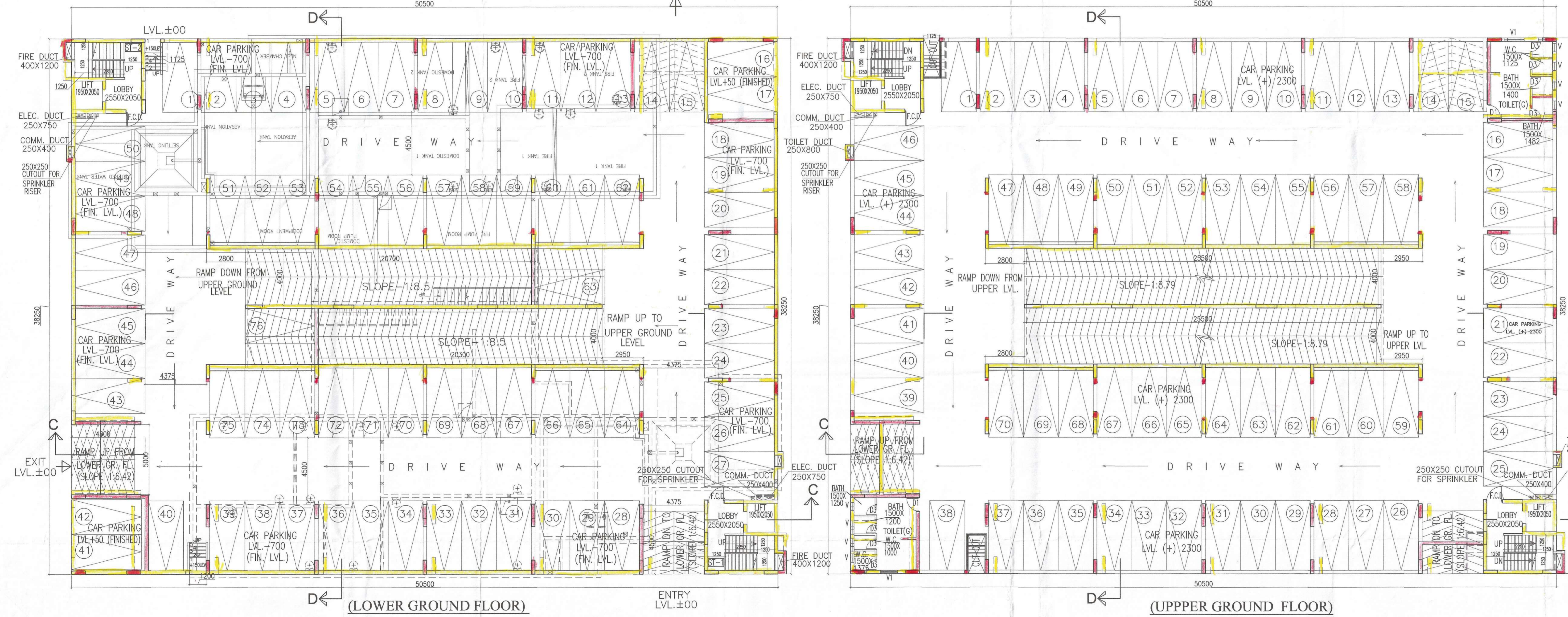

(LOWER GROUND FLOOR)

(UPPPER GROUND FLOOR)

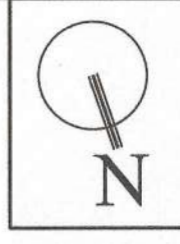

**SCHEDULE OF DOORS & WINDOWS**

| NO     | SILL         | LINTEL | SIZE      |
|--------|--------------|--------|-----------|
| D1A    | —            | 2150   | 1000X2150 |
| D1     | —            | 2150   | 1200X2150 |
| D2     | —            | 2150   | 900X2150  |
| D3     | —            | 2150   | 750X2150  |
| D4     | 250          | 2400   | 1200X2400 |
| F.C.D. | —            | 2150   | 1200X2150 |
| SW8    | 350          | 2150   | 1100X1800 |
| D2A    | 250          | 2400   | 900X2050  |
| V      | ABOVE LINTEL |        |           |

SPRINGCITY BUILDING LLP  
SPRINGCITY ARCHITECTS LLP  
SPRINGCITY ENGINEERS LLP  
Authorized Signatory

SIGNATURE OF OWNER

**CERTIFICATE OF STRUCTURAL ENGINEER.**  
THIS IS TO CERTIFY THAT THE STRUCTURAL DESIGN AND DRAWING OF BOTH FOUNDATION AND SUPER STRUCTURE OF THE BUILDING HAS BEEN MADE BY ME CONSIDERING ALL POSSIBLE LOADS INCLUDING THE SEISMIC LOAD AS PER THE NATIONAL BUILDING CODE OF INDIA AND CERTIFIED THAT IT IS SAFE AND STABLE IN ALL RESPECTS.

SANJIV J. PAREKH  
M.E. STRUCTURE & CONSTRUCTION  
B.C.E. FILE (F-40182-4)  
B.E.S.E. No. 104 (I) K.M.C.

SIGNATURE OF STRUCTURAL ENGG.

SANJIB GUHA  
BSC, BCE, FILE (F-118864-6)  
CHARTERED ENGINEER  
ENLISTED STRUCTURAL  
REVIEWER 8819 K.M.C.

SIGNATURE OF STRUCTURAL REVIEWER.

JUSTIN P. SINGH  
B. Tech (Civil), M.E. (Structural)  
B.C.E. FILE (F-118864-6)  
CHARTERED ENGINEER  
ENLISTED STRUCTURAL  
REVIEWER 8819 K.M.C.

SIGNATURE OF GEO-TECHICAL ENGG.

**CERTIFICATE OF ARCHITECT**  
I DO HEREBY CERTIFY WITH FULL RESPONSIBILITY THAT THE BUILDING PLAN HAS BEEN DRAWN UP AS PER K.M.C. BUILDING RULES - 2009 AS AMENDED FROM TIME TO TIME. THE WIDTH OF THE ABUTTING ROAD CONFORM WITH THE PLAN AND IT IS A BUILDABLE SITE TANK. THE SITE PLAN, LOCATION PLAN AGREES WITH THE SITE. THE PLOT IS DEMARCATED BY BOUNDARY WALLS & MEASUREMENTS TALLY WITH THE REGD. DEED PLAN. THE EXISTING STRUCTURE AS SHOWN FULLY OCCUPIED BY OWNERS AS PER OWNERS UNDERTAKING.

SOUHAYANTOSH  
Arch.  
Reg. No. 1400 (A) 2300

SIGNATURE OF ARCHITECT

TITLE - LOWER GROUND FLOOR PLAN, UPPER GROUND FLOOR PLAN, TYP. FLOOR PLAN (1ST. TO 5TH. FLOOR) & 6TH. FLOOR PLAN BLOCK-B

PROJECT - PLAN SHOWING ADDITION U/S 394 OF K.M.C. ACT 1980 READ WITH U/R -26 (2a)&(2b). AND 69 (A) OF K.M.C. BLDG. RULE 2009 FROM THE SANCTIONED PLAN VIDE BP.NO.- 2016070060, DATED 04.08.16 FOR BLOCK - A (G+XXXIV), BLOCK- B (L+G+UG+VI), BLOCK-C (G+XXXV) & BLOCK -D (G+II) STORED RESIDENTIAL COMPLEX AT PREMISES NO. 33A, CANAL SOUTH ROAD, KOLKATA-15, WARD NO -57, BOROUGH - VII & FURTHER REGULARIZED WITH ADDITION & ALTERATION U/R -26 (2a)&(2b). OF K.M.C. BLDG. RULE 2009 APPROVED BY M.B.C. VIDE BP. NO.- 2016070060, DATED -31.03.2021.

ARCHITECTS

**ACRE ARCHITECTS**  
HOWRAH | KOLKATA | SILIGURI

| SCALE - 1:100   | DATE       | DEALT | CHECKED |
|-----------------|------------|-------|---------|
| SHEET NO.-06/09 | 08.02.2024 | UMA   | SKG     |



